

Specification

Nominal Voltage	2V		
Nominal Capacity(10HR)	65.0AH		
Dimensions	Length	170±2mm (6.69 inches)	
	Width	72±1mm (2.83 inches)	
	Container Height	205±3mm (8.07 inches)	
	Total Height (with Terminal)	212±3mm (8.35 inches)	
	Approx Weight	Approx 4.6 kg (10.1lbs)	
Terminal	T6		
Container Material	ABS		
Rated Capacity	68.2 AH/3.41A	(20hr, 1.80V/cell, 25°C/77°F)	
	65.0 AH/6.50A	(10hr, 1.80V/cell, 25°C/77°F)	
	56.5 AH/11.3A	(5hr, 1.75V/cell, 25°C/77°F)	
	48.9 AH/16.4A	(3hr, 1.75V/cell, 25°C/77°F)	
	39.5 AH/39.5A	(1hr, 1.60V/cell, 25°C/77°F)	
Max. Discharge Current	520A (5s)		
Internal Resistance	Approx 1.8mΩ		
Operating Temp. Range	Discharge	:-15~50°C (5~122°F)	
	Charge	: 0~40°C (32~104°F)	
	Storage	:-15~40°C (5~104°F)	
Nominal Operating Temp. Range	25±3°C (77±5°F)		
Cycle Use	Initial Charging Current less than 19.5A. Voltage	2.4V~2.5V at 25°C(77°F)Temp. Coefficient -5mV/°C	
	Standby Use	No limit on Initial Charging Current Voltage 2.25V~2.3V at 25°C(77°F)Temp. Coefficient -3mV/°C	
Capacity affected by Temperature	40°C (104°F)	103%	
	25°C (77°F)	100%	
	0°C (32°F)	86%	
Self Discharge	Leoch LP series batteries may be stored for up to 6 months at 25°C(77°F) and then a freshening charge is required. For higher temperatures the time interval will be shorter.		

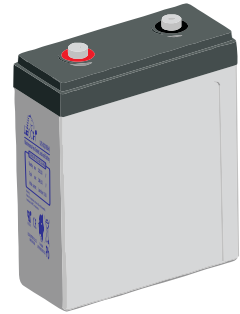

Applications

- ◆ Tele-communication central station (wired or cellular)
- ◆ Power system communication, military communication, etc.
- ◆ Network communication including: data transmission, television signal transmission, etc.
- ◆ Uninterruptable Power System (UPS- for Telecom)



Constant Current Discharge (Amperes) at 25 °C (77°F)

F.V/Time	15min	20min	30min	45min	1h	2h	3h	4h	5h	6h	8h	10h	20h
1.85V/cell	67.0	60.3	49.8	39.5	32.4	19.5	15.1	12.4	10.5	9.20	7.41	6.21	3.29
1.80V/cell	76.1	67.1	53.5	41.6	34.5	20.6	15.8	12.9	11.0	9.61	7.69	6.50	3.41
1.75V/cell	83.6	72.3	56.6	43.7	35.9	21.4	16.4	13.4	11.3	9.84	7.84	6.57	3.45
1.70V/cell	89.2	77.3	59.4	45.4	37.2	22.0	16.8	13.7	11.5	10.0	7.96	6.63	3.48
1.65V/cell	94.0	81.1	62.3	47.3	38.5	22.7	17.2	13.9	11.8	10.2	8.08	6.71	3.53
1.60V/cell	98.6	84.2	64.5	48.6	39.5	23.2	17.6	14.1	11.9	10.3	8.18	6.79	3.57

Constant Power Discharge (Watts) at 25 °C (77°F)

F.V/Time	15min	20min	30min	45min	1h	2h	3h	4h	5h	6h	8h	10h	20h
1.85V/cell	126.8	114.6	95.3	76.0	62.7	37.9	29.4	24.3	20.7	18.2	14.7	12.3	6.56
1.80V/cell	142.1	126.3	101.4	79.4	66.3	39.8	30.7	25.3	21.5	18.9	15.2	12.9	6.78
1.75V/cell	154.0	134.5	106.5	83.0	68.8	41.3	31.8	26.0	22.1	19.3	15.5	13.0	6.84
1.70V/cell	162.6	142.6	110.9	85.5	70.9	42.3	32.5	26.5	22.4	19.6	15.7	13.1	6.91
1.65V/cell	169.3	148.1	115.4	88.8	73.0	43.4	33.1	27.0	22.8	19.9	15.9	13.3	6.99
1.60V/cell	174.6	151.8	118.2	90.3	74.2	44.2	33.6	27.2	23.1	20.1	16.1	13.4	7.06

Specifications subject to change without notice.



Dimensions

T6 Terminal

Unit: mm

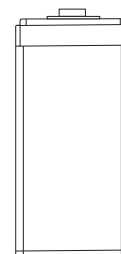
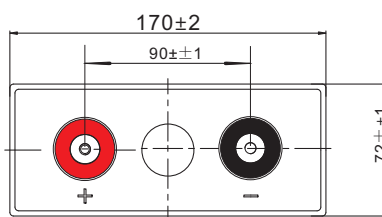
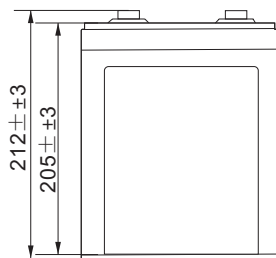
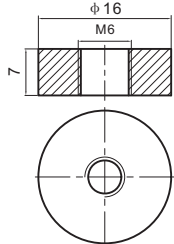

Discharge Characteristics

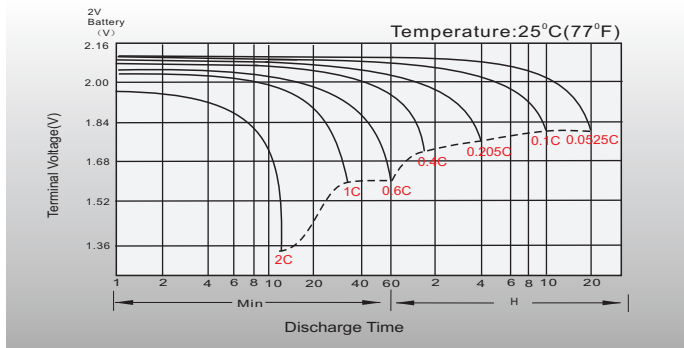

Float Charging Characteristics

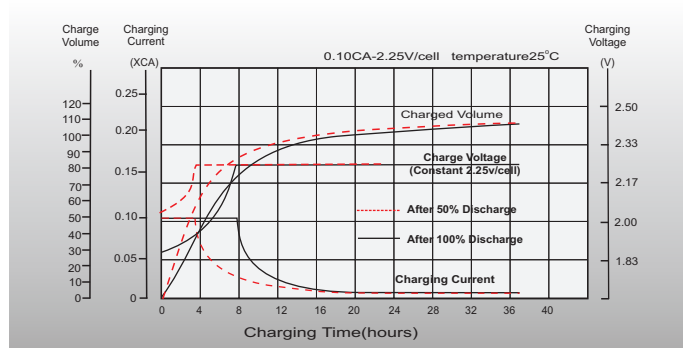

Temperature Effects in Relation to Battery Capacity

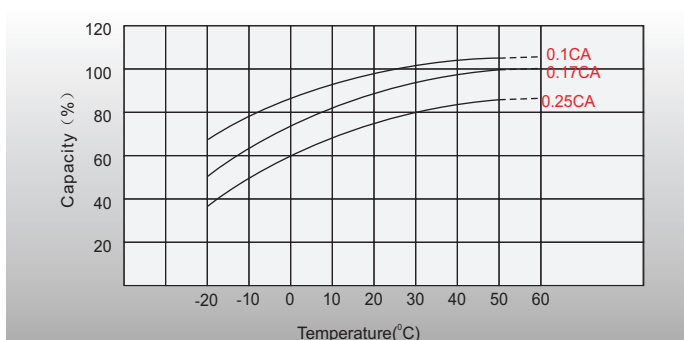

Effect of Temperature on Long Term Float Life

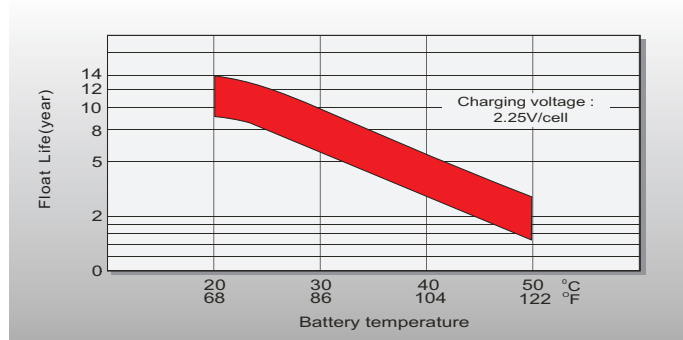

Cycle Life in Relation to Depth of Discharge

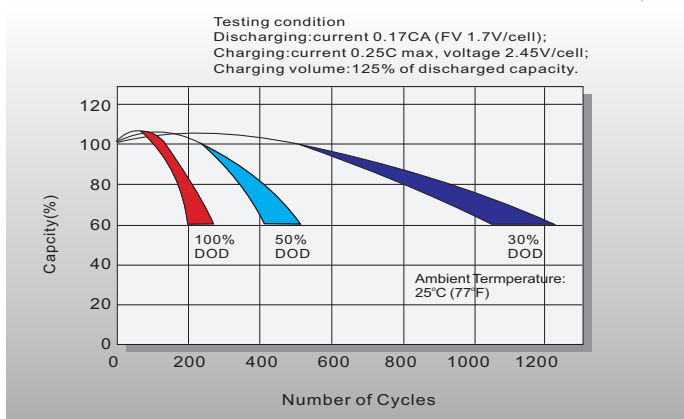

Self Discharge Characteristics

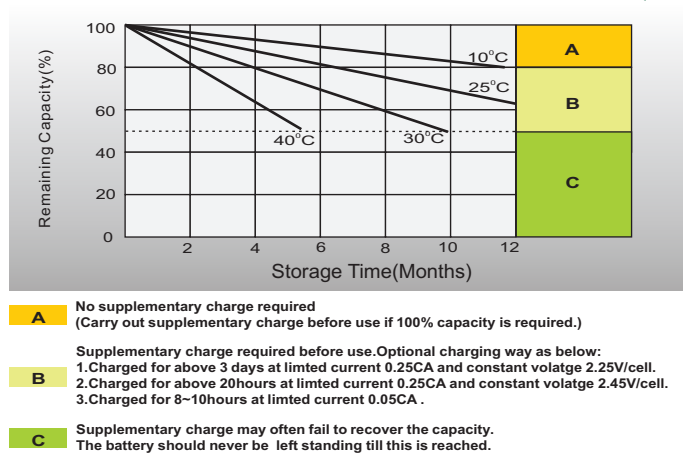

Sales Office

China sales office:

Add: 5th Floor, Xinbaohui Bldg., Nanhai Blvd.,
Nanshan, Shenzhen, China. 518052
Tel: +86-755-86036060 (100 lines)
Fax: +86-755-26067269
E-mail: export@leoch.com
Http://www.leoch.com

HongKong sales office:

Workshop C, 33/F, TML Tower,
No. 3 Hoi Shing Road, Tsuen Wan,
New Territories, Hong Kong
Tel: +852 35786666
Fax: +852 21170016
E-mail: sales.hk@leoch.com

Singapore sales office:

Add: No. 1 Tech Park Crescent,
Singapore 638131
Tel: +65 68636078
Fax: +65 68636079
Email sales.sg@leoch.com
Http://www.leoch.com

North America sales office:

Add: 19751 Descartes, Unit A,
Foothill Ranch, CA 92610, USA
Tel: 949-588-5853
Fax: 949-588-5966
E-mail: sales@leoch.us
Http://www.leoch.com

Europe sales office:

Add: 9B Wheatstone Court, Waterwells
Business Park, Gloucester, GL2-2AQ,
UK United Kingdom
Tel: +44(0) 1452 729428 / 1452 729696
Fax: +44 (0)1452-690125
E-mail: Sales.Europe@leoch.com